

# Using our Water Tank Float Valve Kit for backup water installations

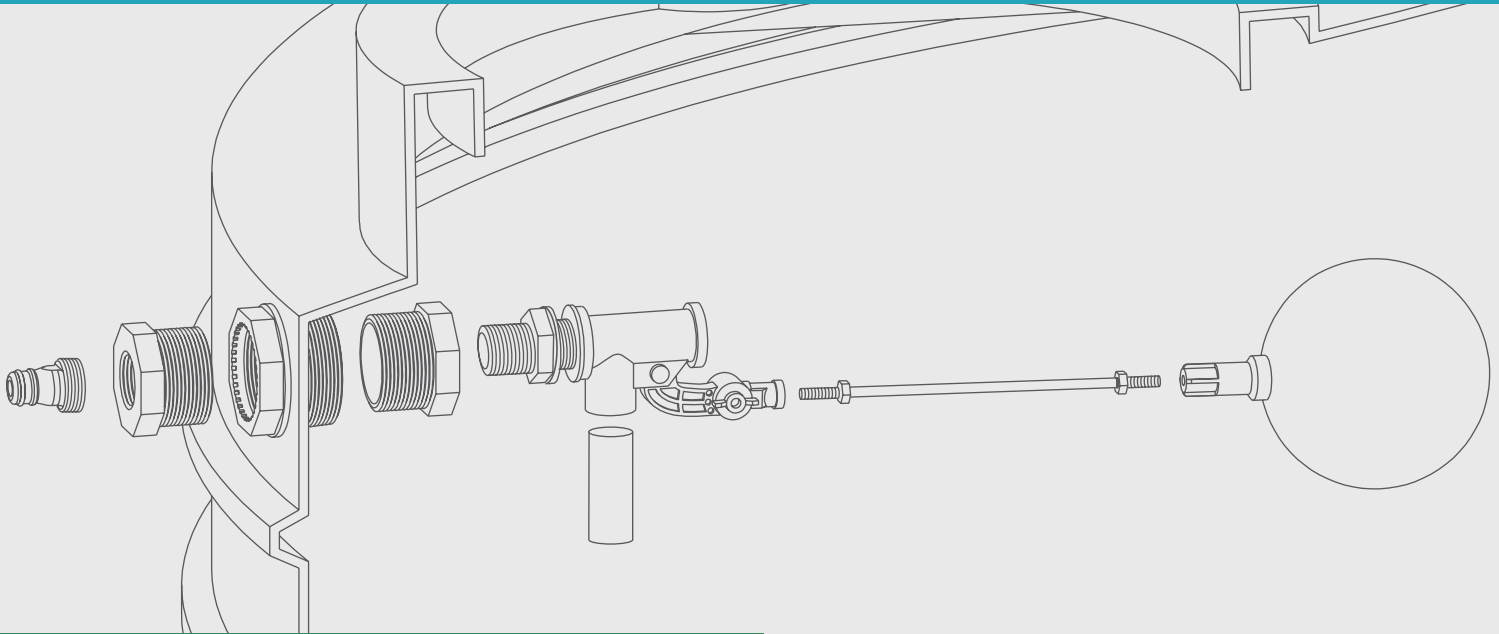

## WHAT'S INCLUDED IN THE KIT?

1. 20mm male hose connector
2. 2x 40/20mm reducers
3. 50/40mm full thread reducer \*\*

\*\* Note: this fitting is only required for tanks bought before the year 2020.

### 4. Float valve

- A Valve
- B Threaded rod
- C Float ball

### 5. Optional hush pipe:

Included to stabilize the float valve and reduce water hammer or bounce (if required) in applications where there are pressure variations.

### Important:

- This unit is not suited for pressure higher than 4 Bar.
- It is advised to use PTFE thread tape on all connections.
- If you bought a JoJo water tank from the year 2020, you will already have a 50/40mm full thread reducer fitted to your inlet, in which case you can keep the one supplied with this kit as a spare.

## APPLICATION

### Connect it to a hose pipe

Pair this kit with a hose pipe for easy filling of your water tank as and when required.

*Note: you will require standard clip-on hose connections to fit your hose to the 20mm male hose connector supplied as part of this kit.*

### Connect it directly to your plumbing

If you want to fill your water tank without manual intervention, connecting it to your plumbing line is the best way to go.

*Note: for this application you will not require the 20mm male hose connector supplied as part of this kit.*

# Using our Water Tank Float Valve Kit for backup water installations

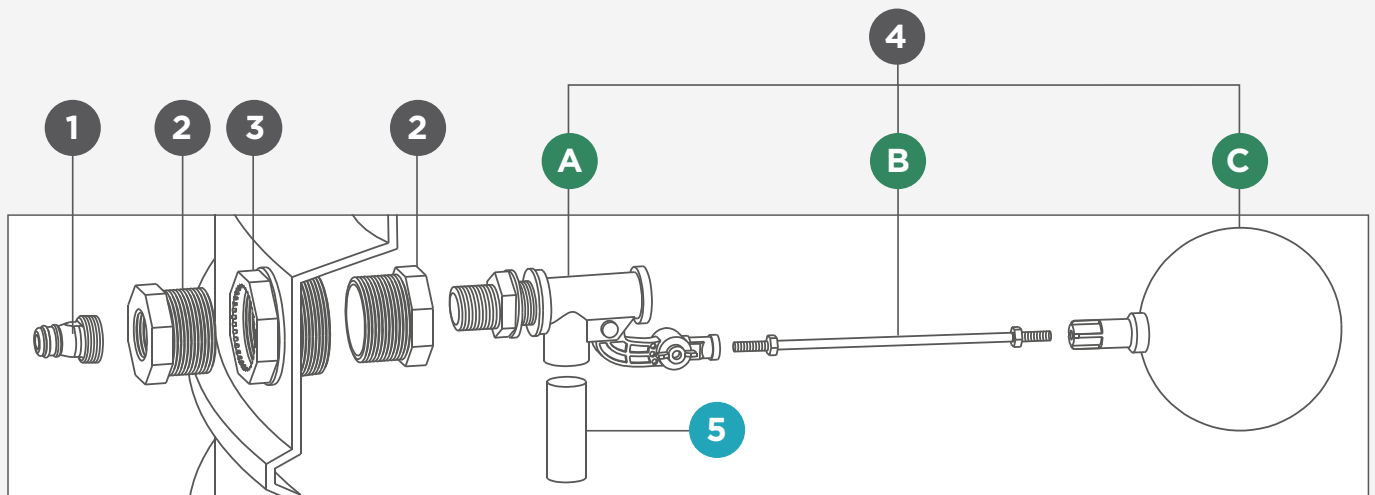

## ASSEMBLY

- 01**  
Assemble the float valve by screwing on both the valve **(A)** and the float ball **(C)** to the threaded rod **(B)**. Tighten the lock nuts to secure the assembly.
- 02**  
Fit the 50/40 full thread reducer **(3)** to your tank inlet. **Tip:** it is advised to utilise the inlet, as it is the fitting closest to the tank lid, which allows for easy access to the assembly when required.  
**\*\* See note on page 1.**
- 03**  
Fit one 40/20mm reducer **(2)** to the front of your 50/40mm full thread reducer **(3)** on the outside of the water tank.
- 04**  
Fit the float valve **(4)** to the other 40/20mm reducer **(2)**, and fit the entire assembly to the inside of your 50/40mm reducer **(3)** on the inside of the water tank.  
**\*\* See note on page 1.**
- 05**  
**Note:** The shut-off height of the float valve can be adjusted by loosening the wingnut on the arm of the valve and angling it to the desired point.
- 06**  
Should you want to fill the tank using a hose pipe, fit the 20mm male hose connector **(1)** to the front of your 40/20mm reducer **(2)**.
- 07**  
If you are not going to use a hose pipe, you can connect your plumbing line directly to the 40/20mm reducer **(2)**.  
**Tip:** use a ball valve in front of your reducer to stop the water flow when maintenance is required.
- 08**  
Now all that is left to do, is to simply fill your tank with water.

### Optional hush pipe:

If required, simply fit **(5)** to the outlet at the bottom of the float valve.